

April 24, 1980

Introduced by: BILL REAMS
Proposed No. 80-594

ORDINANCE NO. 4903

AN ORDINANCE approving the "Stillwater" additions and betterments to the Water District 119 Comprehensive Plan.

PREAMBLE:

On April 10, 1980, Water District 119 passed Resolution No. 103 providing for the "Stillwater" additions and betterments to their comprehensive plan.

These additions and betterments are exempt from the requirements of the State Environmental Policy Act.

As required by KCC Chapter 13.24, the Utilities Technical Review Committee reviewed the proposed additions and betterments and on April 23, 1980 recommended their approval.

BE IT ORDAINED BY THE COUNCIL OF KING COUNTY:

SECTION 1. The "Stillwater" additions and betterments to the Water District 119 Comprehensive Plan as adopted by district Resolution No. 103 (attached) are hereby approved.

INTRODUCED AND READ for the first time this 27th day of May, 1980.

PASSED this 2nd day of June, 1980.

KING COUNTY COUNCIL
KING COUNTY, WASHINGTON

Bill Reams
Chairman

ATTEST:

Dorothy M. Owens
DEPUTY Clerk of the Council

APPROVED this 9th day of June, 1980.

[Signature]
King County Executive

DATE: May 20, 1980

~~MOTION~~
PROPOSED ORDINANCE NO. 80-594 DISTRICT NAME Water District 119

TYPE OF SERVICE XX WATER SEWER

PROPOSED ACTION: Approves additions and betterments for water service to several lots short platted on Kelly Road Northast.

ASSOCIATED ACTIONS: XX Annexation Franchise
 Plat/short plats Plan amendments Additions & betterment
 Building Permit Enforcement Action Other:

Council recently approved (and modified) an annexation for a larger area which included the area which would be provided water service.

PUBLIC HEARINGS: To be shceduled after committee action

LOCATION: Southern portion of Water District 119 southeast of Lake Marcel

SIZE OF AREA: Unknown COUNCIL DISTRICT 3

EXISTING ZONING AND LAND USE:

SE

COMPLIES WITH:

Relationship to County Comprehensive Plan:

 County Sewerage General Plan:

XX Community Plan: no community plan

XX SEPA: Exempt

 Health Problems:

 Safety Problems:

RECOMMENDATION: XX UTRC OTHER:

Recommended approval on April 23, 1980



John D. Spellman
County Executive

King County Courthouse
Seattle, Washington 98104
(206) 344-4040

May 7, 1980

LUM - REAMS - GM

The Honorable Bill Reams
Chairman, King County Council
B U I L D I N G

DRAFT-594

Dear Councilman Reams:

Attached for Council consideration is a proposed Ordinance approving additions and betterments to the Water District 119 Comprehensive Plan. These additions and betterments provide for the extension of water service to many existing lots within the southern portion of Water District 119 near Lake Marcel.

If you have any questions regarding this proposed Ordinance, please contact Irv Berteig at 344-7970.

Sincerely,

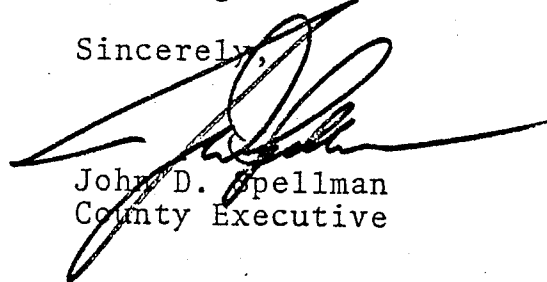

John D. Spellman
County Executive

JDS:mt
Attachment

- ORDINANCE
- COVER LETTER
- MAP
- DISTRICT RESOLUTION
- BACKGROUND

RESOLUTION NO. 103

A RESOLUTION of the Board of Commissioners of King County Water District No. 119, King County, Washington, approving the final annexation of the "Stillwater Road" annexation area, and adopting certain additions and betterments to the comprehensive plan of the District.

WHEREAS, by Resolution No. 97 of the District, dated December 13, 1979, the Board of Commissioners approved the annexation of the following described property into the District:

The Northeast quarter of Section 4, Township 25 North, Range 7 East of the Willamette Meridian; and the East half of the Northwest quarter of said Section 4; and the East 150 feet of the West half of the Northwest quarter of said Section 4; and that portion of the Southeast quarter of said Section 4 lying Northerly of the South right-of-way line of the Carnation-Duvall Road N.E.; and that portion of Government Lot 4, lying Northerly of the South right-of-way line of the Carnation-Duvall Road N.E. in the Northwest quarter of the Northwest quarter of said Section 4.

and

WHEREAS, this annexation was made subject to approval of the King County Boundary Review Board; and

WHEREAS, the King County Boundary Review Board has indicated that the annexation of the said area into King County Water District No. 119 has been approved, such annexation to be effective as of April 14, 1980; and

WHEREAS, the District has previously executed a "Developer's Extension Agreement" with respect to certain water line construction within the annexation area, contingent upon the annexation.

THEREFORE, BE IT RESOLVED by the Board of Commissioners of King County Water District No. 119, as follows:

Section 1. The "Stillwater Road" annexation area, as described hereinabove, is annexed into the District as of April 14, 1980.

Section 2. The District hereby approves of the Developer's Extension Agreement dated _____, 1979, executed by the

District and Mr. Carroll Knight and hereby confirms the District's intention to supply water to the water system to be constructed pursuant to said agreement.

Section 3. The District hereby amends the comprehensive plan of the District to include the water distribution facilities described in the map and specification sheet, which are attached hereto as Exhibits "A" and "B", respectively, and incorporated herein by this reference.

ADOPTED by the Board of Commissioners of King County Water District No. 119, King County, Washington, at a regular meeting of the Board held this 10th day of April, 1980.

KING COUNTY WATER DISTRICT NO. 119

By Andrew D. Kala
President and Commissioner

By Dennis J. Stefani
Commissioner

By _____
Commissioner

ATTEST:

Dennis J. Stefani
Secretary, Board of Commissioners

CERTIFICATION

I, DENNIS STEFANI, Secretary of the Board of Commissioners of King County Water District No. 119, King County, Washington, DO HEREBY CERTIFY that the foregoing is a true and correct copy of Resolution No. 103 of said Board of Commissioners, duly adopted at a regular meeting held on the 10th day of April, 1980.

Dennis J. Stefani
Secretary, Board of Commissioners

ATTACHMENT B

ATTACHMENT 1

Size	On	From	To
8"	Stillwater-Cherry Garden Road	No. line, Sec. 4, T25N, R7E.	PSP&L right-of-way
8"	N.E. 111th Street	Big Rock Road	950' West
8"	N.E. 109th Street	Big Rock Road	1200' West
8"	Easement	N.E. 111th St.	N.E. 112th St.
8"	Easement	N.E. 109th St.	N.E. 108th St.

WATER DISTRICT 119 - STILLWATER

Proposed water service

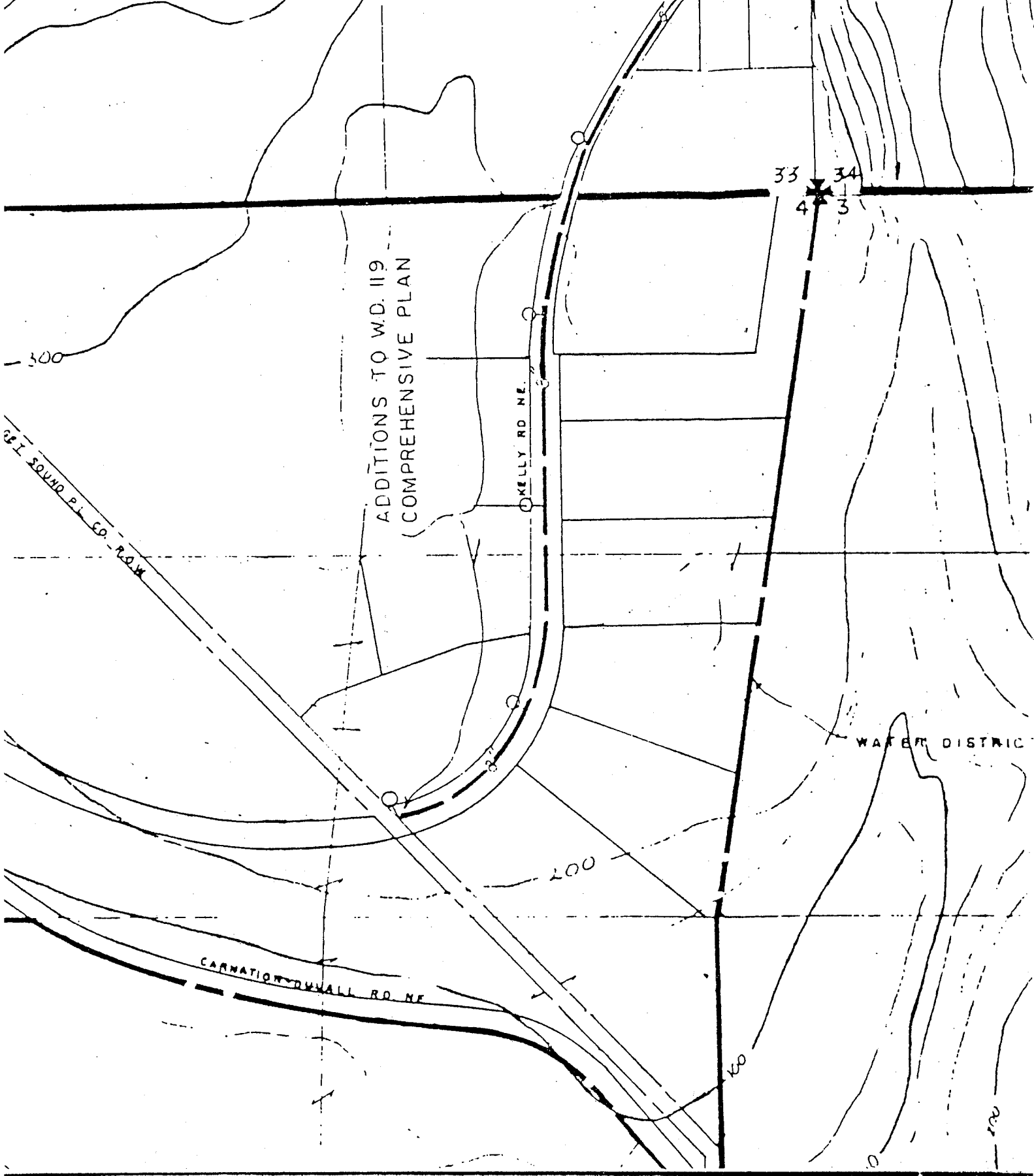

ADDITIONS TO W.D. 119
COMPREHENSIVE PLAN

KELLY RD NE

CARNATION/DWAIN RD NE

WATER DISTRICT

300
300
200
100
33
34
4
3